

L.A. CON

PROGRESS
REPORT
#2

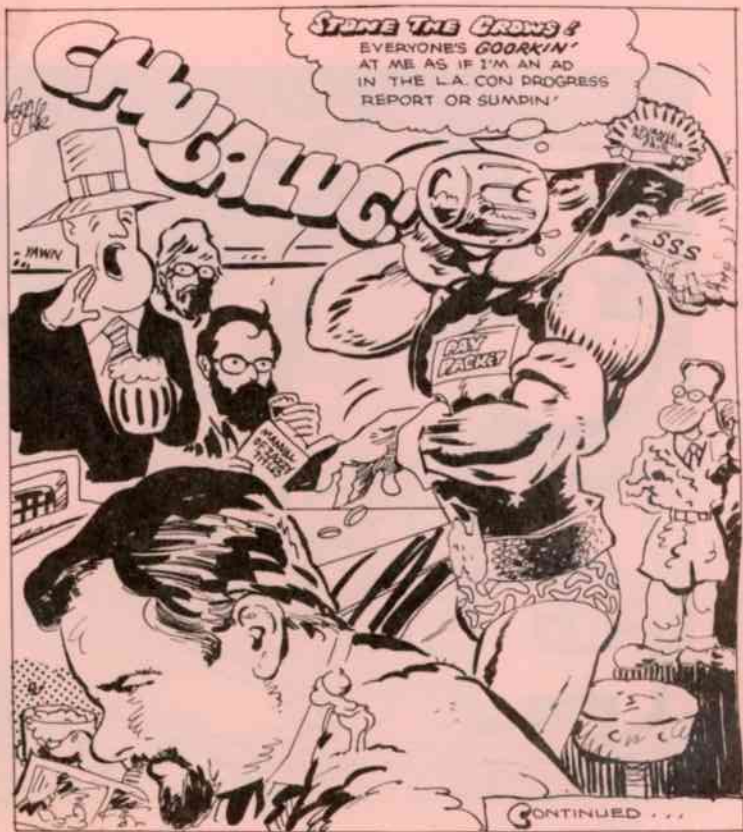

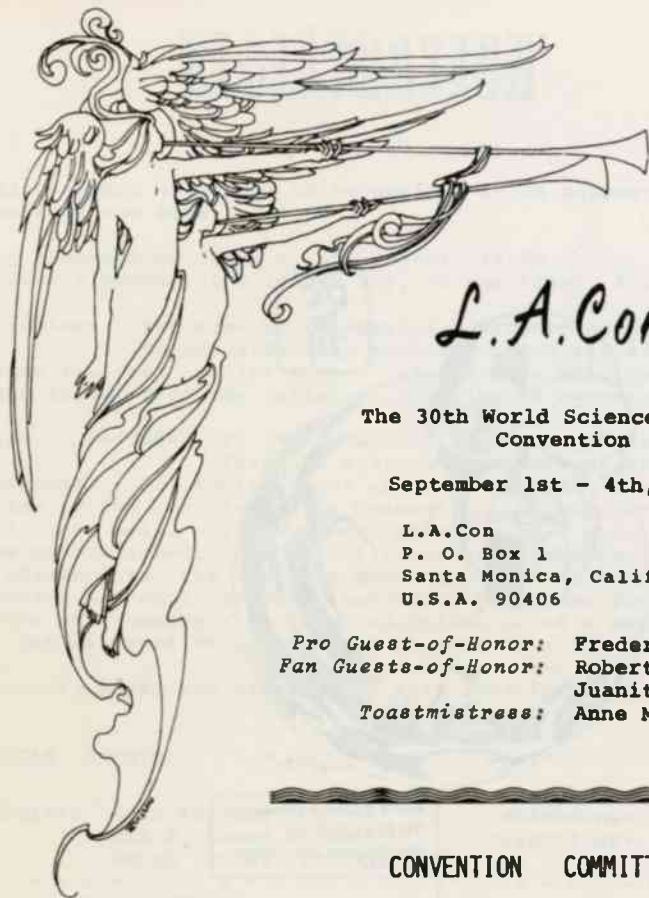



L.A.Con

The 30th World Science Fiction
Convention

September 1st - 4th, 1972.

L.A.Con
P. O. Box 1
Santa Monica, California
U.S.A. 90406

Pro Guest-of-Honor: Frederik Pohl
Fan Guests-of-Honor: Robert &
Juanita Coulson
Toastmistress: Anne McCaffrey

CONVENTION COMMITTEE

Chairmen: Charles Crayne & Bruce Pelz

Public Relations Division: Charles Crayne

Publications & Publicity: Fred Patten

Hotel Relations: Milton F. Stevens

Sales Administrator: Lois Newman

Finances and Program Development Division: Bruce Pelz

Secretary & Program Development: Drew Sanders

Program Coordinator: George Scithers

Audio-Visual: Bill Warren

Masquerade Ball: Al Gillen

Treasurer: Sanford Cohen

Membership: Leslie Kay Swigart

Registration: Gail Knuth

Special Services: Alan E. Frisbie

Auctions: Len Moffatt

Art Show: John & Bjo Trimble



DC
in
74

WSFA Bidding Committee
PO Box 31127
Washington, DC 20031

WE HAVE THE BETTER IDEA

D.C. IN 1974

CO-CHAIRMAN: JAY AND ALICE HALDEMAN
VICE CHAIRMAN: RON BOUNDS
TREASURER: BILL EVANS
SECRETARY: TED PAULS

REGISTRATION

Until 1 August 1972: \$8.00 attending, \$6.00 supporting
After & at the door: \$10.00

Daily memberships (sold at the door): \$5.00
Children's memberships (under 12), at any time: \$3.00

Conversion: The cost of converting a supporting membership to an attending membership is the difference between the cost of the former at the time that you bought it and the cost of the latter at the time of conversion.

Change of Address: It is the member's responsibility to inform the L.A.Con Committee of any change in address. All publications are normally sent to the last address on the records of the Convention, by non-forwardable Third Class mail. If you move, please send a Change of Address notice immediately to the Convention; the Committee is not responsible for tracking down such COAs in fannish news sources. Any publications returned to us by the Post Office because of a member's failure to inform us of a new address will not be remailed except upon payment of a 50¢ fee.

Membership cards are distributed with this Progress Report.

OVERSEAS AGENTS:

Australia: John Foyster attending: \$8 U.S.
c/o 6 Clowes Street supporting: \$6 U.S.
South Yarra, Victoria 3141

Belgium: Michel Feron attending: 400 fr.
Grand-Place 7 supporting: 300 fr.
B-4280 Hannut

Germany: Mario Bosnyak attending: 27 DM

Austria: Feldbergstrasse 26-a supporting: 20 DM

Helvetia: D-6272 Niedernhausen
Bundesrepublik Deutschland

Italy: Gian Paolo Cossato attending: lire 4,500
Cannaregio 3825 supporting: lire 3,500
30121 Venezia

Netherlands: Kees van Toorn attending: f 25
Marinestraat 9-c supporting: f 20
Rotterdam 1, Zuid-Holland

Sweden: John-Henri Holmberg attending: 40 kr.
Norrskogsvägen 8 supporting: 30 kr.
S-112 64 Stockholm

United Kingdom: Peter Roberts attending: £3.25
The Hawthorns supporting: £2.50
Keele, Staffs., England

RIVERSIDE QUARTERLY

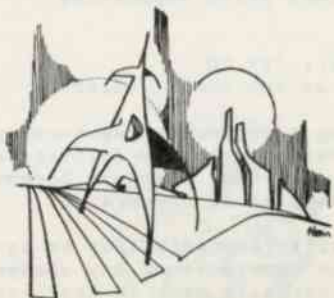

THE LITERARY MAGAZINE FOR
SCIENCE FICTION AND FANTASY

Other Magazines Promise It...

RQ Delivers It!

in recent and future issues --

"Animism & Magic in Tolkien's
The Lord of the Rings"

--Pat Callahan

"Utopia for Poets & Witches"

--Fritz Leiber

"Gernsback 'Magazines' No One
Knows" -- Sam Moskowitz

"Sex & Prudery in Edgar Rice
Burroughs & H. R. Haggard"

-- Dale Mullen

"Omnipotent Cannibals"

--Robert Plank

"S.F. as Will & Idea: The
World of Alfred Bester"

--Jeff Rigenbach

"Mythology in Samuel Delany's
The Einstein Intersection"

--Stephen Scobie

"Warlocks and Warriors"

--Darrell Schweitzer

...plus Jim Blish, John Boardman, John Campbell, Richard Kyle,
Sandra Miesel, Alexei Panshin, Jack Williamson, Roger Zelazny...

...plus columns by Bill Blackbeard, Jim Harmon, Harry Warner....

...plus book reviews by J.R. Christopher, Wayne Connelly,
Ted Pauls, etc....

Subscriptions \$2 (four issues) from:

RIVERSIDE QUARTERLY
Box 40 University Station
Regina, Canada

Note: All 16 back issues are either currently available at
50¢ each or--in the case of numbers 1 and 3--scheduled for
reprinting (at same price) sometime in '71.

Special Offer: A \$5 (or larger) order brings you a free copy of
H.P. Lovecraft: A Symposium, with Bob Bloch, Arthur Cox, Fritz
Leiber, & Sam Russell. Three copies of this 2nd edition are avail-
able in Australia--but none is available elsewhere at any price.

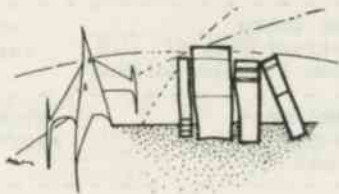

BANQUET

The Awards Presentation Banquet will be held on Sunday, September 3, 1972. The menu will be:

appetizer: Supreme of fresh California fruit
main course: Roast Vermont turkey, special dressing, giblet
 gravy, cranberry sauce
OR: Broiled Eastern halibut steak, parsley butter
 * Fresh oven baked assorted rolls and butter *
dessert: Ice cream cake, strawberry sauce
 Coffee or Tea or Milk

Tickets purchased by mail in advance of the L.A.Con are discounted from those purchased at the Convention. The absolute deadline for Banquet tickets is 0900 (a.m.), Sunday morning. Due to the vagaries of the postal system, Banquet tickets will not be sold by mail after 15 August 1972.

All seating at the Banquet will be assigned. Seats will be assigned in the order received. Groups wishing to sit together may reserve an entire table (ten persons) by purchasing their tickets in a single order. There is a discount given to groups doing so. In addition ticket holders who are part of a table group will be admitted to the Banquet hall first. Group reservations will be available for sale through advance order by mail only, and not at the Convention.

Prices (same for either entree):

<i>Mail order (until 15 August 1971):</i>		<i>Purchased at the</i>
<i>as part of entire</i>	<i>less than entire</i>	<i>Convention</i>
<i>table (10 people)</i>	<i>table quantity</i>	
\$7.00	\$7.25	\$8.00

Note: You must decide whether you want turkey or salmon at the time you order your ticket.

The hotel will provide wine service at the Banquet. A wine list will be provided at each table. The wines are not included in the Banquet price. Ordering and payment for wines must be done on an individual basis.

The Banquet hall will be closed to all non-diners during the meal. After the meal and before any of the presentations or speeches begin, the doors will be opened to allow non-diners into the rear of the room.

Checks for all Banquet tickets should be made payable to the L.A.Con. Please do not send cash through the mails.

MEMBERSHIP

219. Forrest J Ackerman
220. Wendayne Ackerman
221. Richard J. Daniels
222. Michael Ward
223. J. Collette
224. Irvin Koch
225. Paul Crawford
226. Clive A. Church
227. Harvey L. Bilker
228. Francis X. Robinson, Jr.
229. T. L. Sherred
230. J. A. Corrick, III
231. Perri Corrick
232. John M. Cawley, Jr.
233. Donald O. Nelson
234. Claire Beck
235. Bruce Newrock
236. Florence Newrock
237. Dick Emanuel
238. India May Boone
239. Al Lewis
240. Linda Lewis
241. Robert E. Briney
242. Bill McLean
243. Harold Moellendick
244. Thomas Jefferson Soyer
245. Terry Hughes
246. Mark A. Swanson
247. Mark Owings
248. Paul R. Dorethy
249. C. M. Drahan
250. Timothy M. Nagle
251. Cuyler W. Brooks, Jr.
252. Robert Colby
253. Bruce Gillespie
254. Lee Harding
255. Elizabeth Foyster
256. The Sydney Science
Fiction Foundation
257. The Australian Tolkien
Society
258. Paul Anderson
259. Melbourne SF Club
260. Roman Mazurak
261. Bill Wright
262. Cedric Rowley
263. John Breden
264. Tony Thomas
265. Alan Sandercock
266. Daryl Lindquist
267. Philip Dalkin
268. James A. Campbell
269. The Nova Mob
270. John Bangsund
271. Peter Roberts
272. Joe R. Christopher
273. Terry D. Decker
274. Dieter Steinseifer
275. Allan Timpe
276. John F. Cullin
277. Malcolm Edwards
278. John-Henri Holmberg
279. Terry Adamski
280. Julie M. Funn
281. Rob Solomon
282. George Senda
283. Cliveden Chew
284. Mary Ann Cappa
285. Guy Haas
286. Phillip McDown
287. Patricia McDown
288. Cathy Minner
289. Barbara Hyde
290. C. A. Brainard
291. William Bunker
292. Greg Benford
293. Clarica Scott
294. Roy Lavender
295. Deedee Lavender
296. Virgil Niter
297. Lois Newman
298. Bill Denholm
299. Rita Ractliffe
300. Mike McInerney
301. Barbara Dodge
302. Routt Bryant III
303. Erik Fennel
304. Eileen Becker
305. J. Ben Stark
306. Hal Bertram
307. Alicia Austin
308. Maureen Wilson
309. Keith Wilson
310. John Pound
311. Mark Mumper
312. Wayne H. Jones
313. Ellen Fox
314. J. C. Haldeman II
315. Alice Haldeman
316. Frances W. Evans
317. John Piggott
318. D. Ann Bowen
319. Doug Finley
320. Gregory P. Feeley
321. Rachel Roberts
322. Janet Izuno
323. Jenny Griffin
324. Karen Hedlund
325. Marilyn Chase
326. Ed Connor
327. Mike Wood
328. G. Kaku
329. Myron Rapkin
330. Joan Rapkin

- 331. Cathy Bushman
- 332. President, LRCBC+DF
- 333. Vice-President, LRCRC+DF
- 334. Jay Freeman
- 335. New England Science Fiction Association
- 336. Mrs. Marjorie Gilbert
- 337. Richard Harter
- 338. Jill L. Eastlake
- 339. Wendell Ing
- 340. Fred Isaacs
- 341. Michael Gilbert
- 342. Warren De Priest
- 343. Carol Hoag
- 344. Julian Gomez
- 345. Leif Andersson
- 346. David Grigg
- 347. Tom Whitmore
- 348. John Blattman
- 349. Norma Green
- 350. Jock McKenna
- 351. Lewis Wolkoff

FILM PROGRAM

The L.A.Con is in the process of planning a comprehensive & unusual film program, and hopes to have films running during most of the Con. A large list of films, professional & amateur, well-known & obscure, is already under consideration. In order to select the films that fans most want to see, the Committee is open to suggestions from the public. Recommendations of titles are welcome and recommendations of sources of availability are especially welcome! The Committee would also like to put out a call now for volunteer projectionists with experience in handling projectors. Address all letters to Bill Warren, c/o the L.A.Con address.

HUCKSTERS

Hucksters and others wanting to buy table space in our Hucksters' Room may contact Lois Newman, at the L.A.Con address, for information as to table rates, et al. Please state your specific needs (i.e., how many tables you'll want, if you'll want any special configurations, etc.) when requesting this information. Tables and table space will be assigned on a first come basis. The Hotel has 200 tables 8' long that are available for us; anything else will have to be obtained especially. We would also like to poll prospective hucksters as to whether they would prefer to have the Hucksters' Room close early in the evening or stay open late into the night, whether they plan to close up shop during the major program items such as the Banquet, the Masquerade, etc., or whether they would rather remain open for business, and so on. This information is needed to help us determine what hours to set for the Hucksters' Room, and is an important factor in cost planning since the Con will be hiring guards for the period that the Room is open.

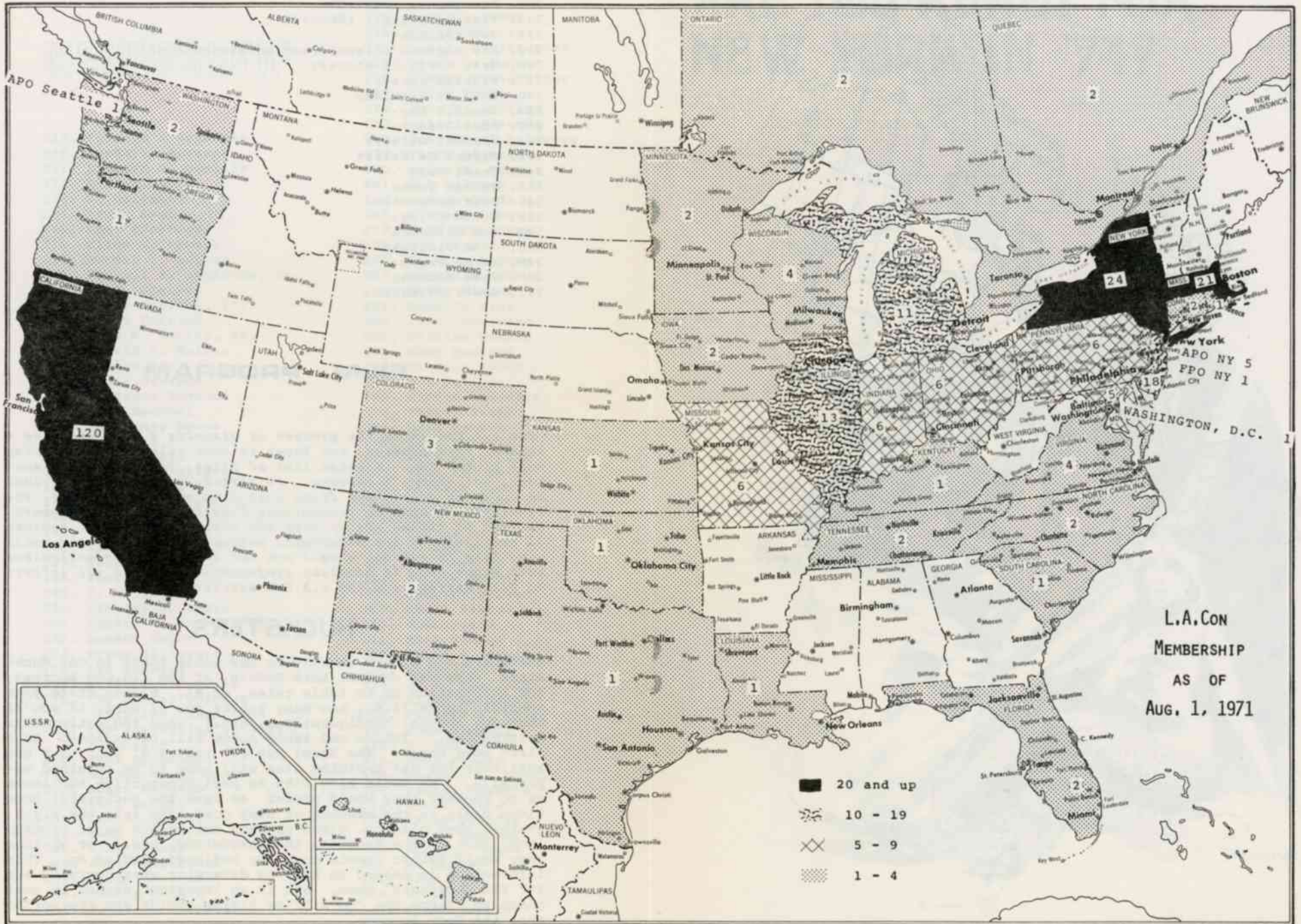



ARE YOU READY FOR NEW YORK IN '74?



F. KRZYWICKI



THE NEWSLETTER OF
THE SCIENCE FICTION FIELD

THREE YEARS CONTINUOUS
BI-WEEKLY PUBLICATION

HUGO RUNNER-UP FOR 1969

Comprehensive
Information On:

BOOKS
MAGAZINES
CONVENTIONS
AUTHORS
FANS
FANZINES

Outstanding
Artists:

GAUGHAN
AUSTIN
BARR
KIRK
DIFATE
PLUS MANY OTHERS

IN FACT, EVERYTHING OF INTEREST TO THE SCIENCE FICTION ENTHUSIAST!

*\$3 for 12 issues**

LOCUS
2078 Anthony Ave.
Bronx NY 10457

* Airmail: Europe, 10/\$3.50; Australia, 10/A\$3.50.

THE HOTEL

The L.A.Con will be held at the:

International Hotel
6211 West Century Boulevard
Los Angeles, California 90045

The International Hotel is right next to the Los Angeles International Airport, and provides free 24-hour transportation from the Airport to the Hotel. It is a new, completely soundproofed, 14-story hotel.

Here are some excerpts from the signed Agreement between the L.A.Con Committee and the Hotel, to show what we're getting:

All convention facilities are assigned to the use of the Committee on a 24 hour a day basis during the period of the Convention, (Friday, September 1 through Monday, September 4). Provisions will be made for the pre-Convention needs for setting up the art and book rooms and for making a room available for registration the day before the Convention officially begins (August 31). The Committee will inform the Hotel of its exact needs at least one month before the Convention.

That covers all-night movies, among other things.

Projectionists operating hotel owned equipment and paid performers shall be union members. Privately owned or rented projection equipment need not be operated by union members.

Sleeping rooms shall be rented at the following rates: \$14 a day for single occupancy, \$16 a day for double occupancy, \$18 a day for triple occupancy, and \$20 a day for quadruple occupancy. Cabanas will be rented at the same price as other rooms.

The Hotel shall book all available sleeping rooms for the Convention until thirty days prior to the Convention, after which unused rooms will be released to the Hotel. The Hotel shall not oversell these rooms.

Reservations may be made until seven days before the Convention. A \$10 deposit will be required for rooms reserved after 6 P.M. on the first day of the Convention.

The Hotel will cooperate with the Committee in pre-assigning sleeping rooms.

The above three items mean that the L.A.Con has the priority on booking rooms at the Hotel for the period of the Con, up until 30 days before the Con. At that time, the Hotel will reserve any remaining sleeping rooms on a first come basis,

whether the requestor is a member of our group or not, and fans will have to take their chances. Reservations will not be accepted after the period beginning seven days before the start of the Con. This, plus the fact that the Hotel gets a great amount of trade from the Airport, means that there is virtually no chance of arriving at the Con without a reservation and expecting rooms. To ensure that the maximum possible number of fans get the 650 rooms in the Hotel for the duration of the Con, all attending members are urged to send in their reservations early. Registration cards will be included with Progress Report #3.

All rooms are carpetted, with individual temperature control and TV and radios. These include the poolside cabanas (also soundproofed). If you have some preference as to the location of your room in the Hotel, please advise the Committee, and we will do what we can to accommodate you. Those who're planning to host late-night room parties or who'd like their rooms near that vicinity are requested to make their desires known to the Committee, as are those who'd prefer a quieter area of the Hotel, so that we can try to satisfy everyone.

Schedules for hotel bars and restaurants will be as follows during the Convention:

Penthouse Lounge	5:00 PM - 2:00 AM
Penthouse Dining Room	6:00 PM-10:30 PM/closed Mon. & Tues.
Trophy Lounge	11:30 AM - 1:30 AM
Hunt Room	11:30 AM - 3:00 PM/5:30 PM - 11:00 PM
Coffee Shop	6:00 AM - 3:00 AM
Hideaway Lounge	9:00 AM - 12:00 Midnight

The Coffee Shop will be staffed for a full hotel during the Convention.

Aside from health and safety regulations, the only dress requirement which will be in effect during the Convention is that a jacket must be worn in the Penthouse Restaurant.

Note the 21-hour Coffee Shop, which happens to be brightly-lit and has seating for about 250 persons.

The Committee will notify the Hotel of its requirements for cash bars at least 30 days before the Convention. The Hotel will provide cash bars for a minimum of \$100 in bar receipts for each four hour period of operation.

This is the special convention bar that we've planned in the lounge at the entrance to the Art Show. In addition to the drinks, sandwiches will be available for those who want only a quick snack without having to leave the Con area. This is an experiment -- if we can't supply \$100 worth of trade for each four-hour period the bar is open, it'll regretfully be closed.

Room service will be available from 6:00 AM to 2:00 AM daily.

The Hotel will provide free parking for registered guests. Non-guests may use either the 50¢ or \$1 valet parking.

The Hotel will augment its staff to help with check-in and check-out.

In order to accommodate the luggage of those guests who are staying past the 2:00 PM check-out time, the check-out time will be extended on an adequate number of rooms.

The Hotel will provide safety deposit boxes for the storage of valuables. A \$10 fully refundable deposit will be required for this service.

Elevators will not be taken out of service for routine repairs or maintenance during the Convention.

The swimming pool will be open 24 hours a day during the Convention. The use of safe (i.e. plastic) water toys is permitted in the pool.

Though it's not in the Agreement, the Hotel's check cashing policy is to require a driver's license for identification, plus a check guarantee card or a credit card. The Hotel accepts the following credit cards:

American Express	Schenleys
BankAmericard	Master Charge
Carte Blanche	Diners Club

Travelers' cheques are always convenient.

Fans visiting the Los Angeles area will doubtlessly want to see some of the other sights that Southern California has to offer -- Disneyland, the Griffith Park Planetarium (used by Hollywood as an observatory, a castle, or secret laboratory in many movies and TV shows), motion-picture studios, zoos & African preserves, visit the Mexican city of Tijuana (less than 2 hours' drive away), etc. None of these really have any connection with science-fiction, and therefore no Convention program items connected with them will be scheduled. However, since a large number of fans may want to see these anyway, and in the company of other fans, the Con Committee will try to schedule some unofficial trips during the week before &/or after the L.A.Con. If you're planning to arrive at the Con early, or stay a few days afterward, and you would like to join a fannish outing to one of these places, please contact the Committee so that we can try to arrange a schedule to the most popular attractions, at the most convenient time for the majority.

On the next page is a map of the Convention floor (the mezzanine) of the Hotel, marked as to our probable usage of it. This is tentative; the arrangement may be shifted, depending upon such factors as the actual amount of art entered in the Art Show, the amount of table space bought by the hucksters, etc. There are also convention facilities on other floors, which will most probably be used for luncheons and meetings of special interest groups.

LOS ANGELES

International HOTEL

SWIMMING POOL

CONVENTION, EXHIBIT, MEETING
AND BANQUET AREA

An entire floor of convention, exhibit, meeting and banquet space completely versatile as to configuration and adaptable to any group requirement. All rooms on this floor are serviced by an adjacent fully-staffed kitchen to assure prompt and efficient service

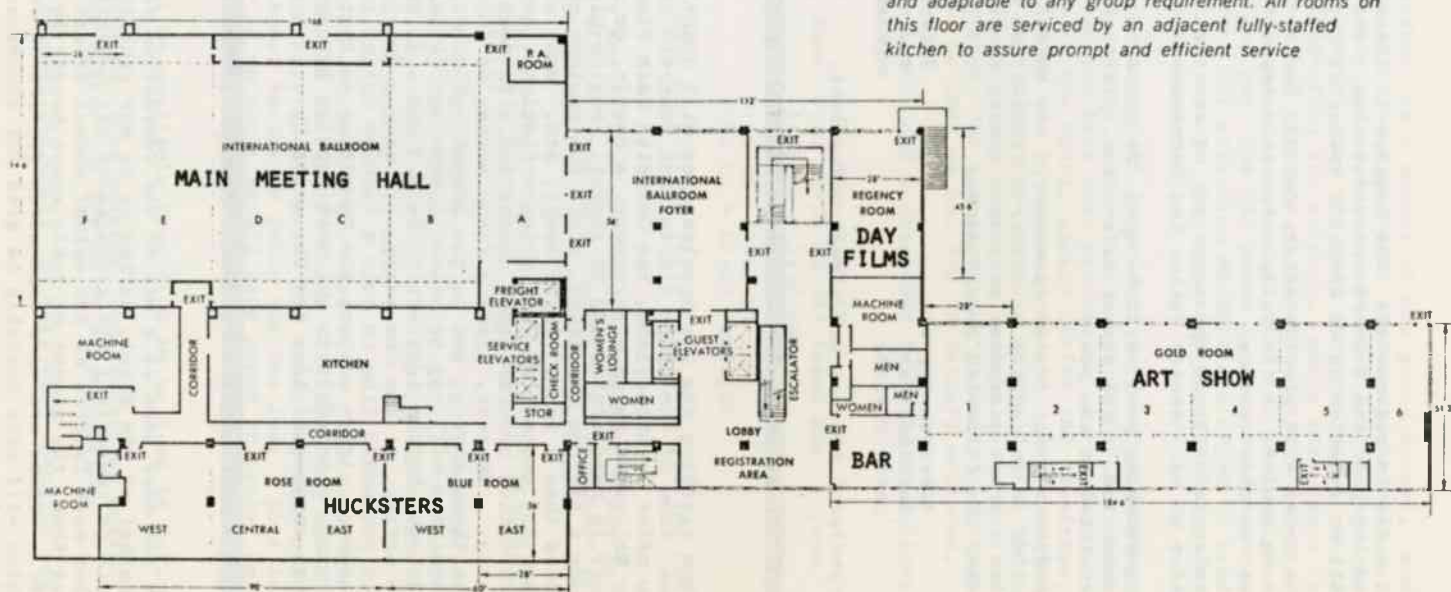

ADVERTISING

PR:	Ad Deadline	Publication:	Rates:
3	Dec. 15, 1971	Jan. 1, 1972	Fan: \$10.00 - 1 page
4	May 15, 1972	June 1, 1972	\$ 7.50 - ¼ page
PB	July 1, 1972	Aug. 1, 1972	\$ 4.00 - ¼ page
FR	Nov. 15, 1972	Dec. 1, 1972	\$ 2.00 - 1 line

Dimensions:	Full page - 6" x 10½"	Pro: \$20.00 - 1 page
	Half page - 6" x 5½"	\$15.00 - ¼ page
	Quarter page - 3" x 5½"	\$ 7.00 - ¼ page

All dimensions are image area, and are exclusive of margins. They'll be shot at 2/3, creating a 1/3 reduction and making their own margins. All ads must be submitted in camera-ready copy. There will be a charge of \$5 for correcting incorrect material to a camera-ready state, for half-toning photographs, or for printing in any color other than black.

Program Book Rates:

Fan:	\$12.50 - 1 page
	\$10.00 - ¼ page
	\$ 6.00 - ¼ page
	\$ 2.50 - 1 line
Pro:	\$25.00 - 1 page
	\$20.00 - ¼ page
	\$10.00 - ¼ page

Please add a cardboard stiffener when you mail your ad copy to provide for protection while in the mail.

Make all checks payable to: L.A.Con.
Send all copy to Fred Patten, c/o the L.A.Con address.

The Art Show

The tentatively-scheduled Art Show location announced in our last Progress Report has been changed. The new location is approx. 9,000 sq. ft., more appropriate to the expected size of the Art Show. The special convention bar will be set up in the lounge area at the entrance to the Art Show. Convention membership badges will be required for entry.

The International Science Fantasy Art Exhibition will be arranged and managed by John & Bjo Trimble. Anyone interested in entering artwork (including paintings, sculpture, amateur films, photographs, etc.), or in sponsoring an award trophy, should send a request for information and a stamp for entry forms and the new Art Show rules to:

John & Bjo Trimble
869 Irolo Street
Los Angeles, California
U.S.A. 90005

Telephone: (213) 386-7945

EUROCON 1

Trieste 1972

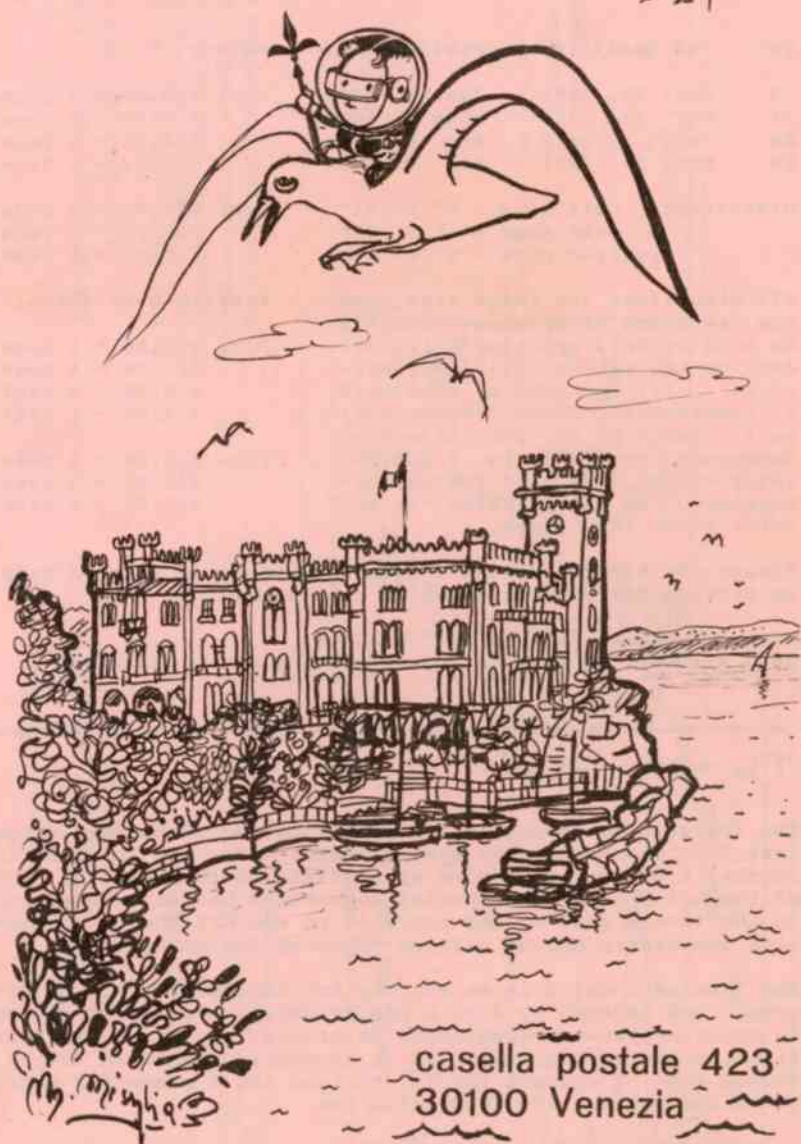

casella postale 423
30100 Venezia

Convention Memberships: Attending \$ 7.00; Supporting \$ 4.00